



Smart Door Lock D100 Zigbee Edition User Manual

Product Introduction

Aqara Smart Door Lock D100 Zigbee Edition incorporates multiple ways of unlocking including: fingerprint, password, Bluetooth of the mobile phone, NFC and mechanical key. The integrated lock body can enable the full-automatic function of opening (automatic unlock) at one touch as well as automatic locking. The door lock is featured with such functions as lock state inspection, low battery reminders, lockpicking warning and error trial warning. Meanwhile, Aqara Home and Apple HomeKit are already supported, which means that the lock can cooperate with other smart devices that support Aqara or HomeKit to fulfill the multiple functions in smart home applications like smart automation control and alarm.

* Aqara hub is required to receive the abnormal state warnings, check unlock records remotely, perform smart automation, initiate the away mode and other relevant functions.

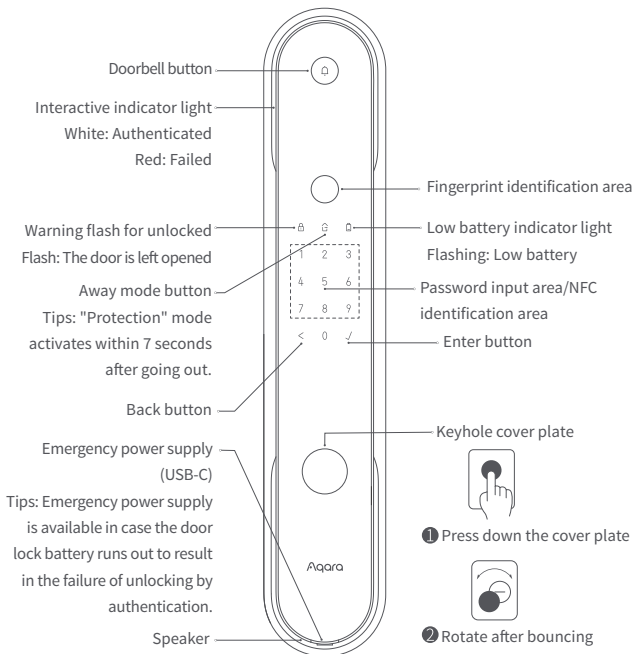

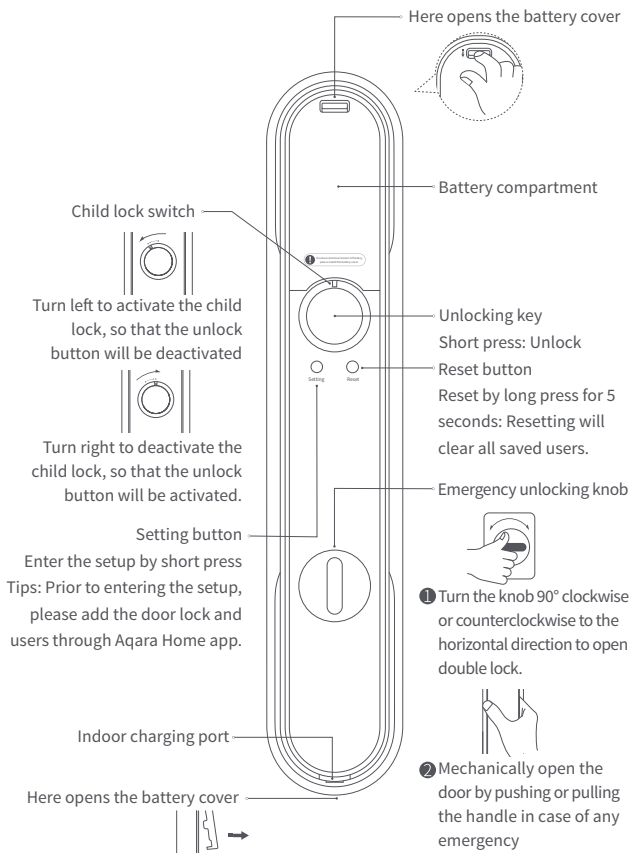

Door Lock Installation

Please hire professionals to install as the dangerous professional tools are used in the process of installation.



Scan the code to reserve the installation or check the electronic instruction.

Preparation for Use

① Please open the battery cover and install the lithium battery.

⚠ When it is in low power, please replace it in time, otherwise the power running out will lead to the failure to open the door by authentication (able to plug in USB-C emergency power supply or open the door through mechanical key).

② Press and hold the "Reset" button for 5 seconds, release it after hearing the voice prompt, and so the resetting is finished.

Notes: The user information will be cleared after resetting thus the door will be unable to be locked. Please finish the door lock setting according to this instruction as soon as possible.

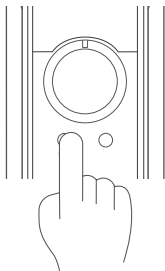

Press and hold for 5 seconds and release after hearing the voice prompt

Quick Setup

① Add the device to the Aqara Home app

Search for "Aqara Home" in the Apple App Store, Google Play, Xiaomi GetApps, Huawei App Gallery, or scan the following QR code to download the Aqara Home app. Open the home page of this app, and click "+" in the upper right corner of the page to add the device as prompted.



Tips: Following adding, the hub device under the account will be automatically connected without manual configuration. The Bluetooth communication can take effect within 10 meters and its distance may be affected by the wall and other obstacles.

② Adding the users

Add the user to enter the door lock device page to add the owner (administrator by default) as the app prompts.

Notes: The lock will not be locked normally without adding the user.

③ Adding the device to HomeKit (for iOS users)

When the door lock first powered, open the Apple "Home" app, click "+" in the upper right corner to select "Add Accessory", scan or manually enter the HomeKit setting code according to the prompt (open the indoor battery cover to get the HomeKit setting code), and complete the addition operation according to the prompt. Currently HomeKit is exclusively available to lock or unlock and set the smart automation control.

User Instructions

1. This device works with HomeKit technology. Controlling this HomeKit-enabled accessory automatically and away from home requires a Apple TV (the 4th generation with tvOS 12.0 or higher), iPad (iOS 12.0 or higher), or HomePod set up as a home hub, and iPod, iPhone or iPad (iOS 12.0 or higher).
2. Communication between this product and iPhone, iPad, Apple TV and HomePod is secured by HomeKit technology.
3. Use of the Works with Apple badge means that an accessory has been designed to work specifically with the technology identified in the badge and has been certified by the developer to meet Apple performance standards. Apple is not responsible for the operation of this device or its compliance with safety and regulatory standards.
4. Apple, HomeKit, HomePod, iPad, Apple TV and iPhone are trademarks of Apple Inc. registered in the U.S. and other countries.



How to Use

Successful authentication: Interactive indicator flashes in white with the authentication sound prompt in case of no silent mode enabled.

Authentication failed: Interactive indicator flashes in red with failed sound prompt in case of no silent mode enabled.

1. Unlock by fingerprint



- ① Attach the finger to the fingerprint identification area;
- ② After passing the authentication, push or pull the handle to open the door.

2. Unlock by password



1



2

- 1 Enter the password and press the Enter button;
- 2 After passing the authentication, push or pull the handle to open the door.

3. Unlock by the emergency key



1



2



3

- 1 Press down the cover plate of the emergency keyhole;
- 2 Rotate the cover plate after it bounced back;
- 3 Insert and rotate the key to unlock.

Notes: Do not put the emergency key in the house, but keep it in a safe and accessible place for the use in case of emergency.

4. Unlock from indoors



1



2



- 1 Turn the child lock switch to the right position to release the lock of the button
- 2 After short pressing the button for opening, push or pull the handle to open the door.

5. Charge the Lithium battery

Remove the battery for charging:



1



2

- 1 After opening the back panel cover, press down the battery cover to disassemble switch and open the battery cover;
- 2 Take out the lithium battery and charge it with USB-C charging cable.

Charging is ongoing if the indicator light is in red;

The battery is fully charged when the indicator light is in green.

Directly charge on the door:

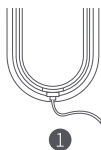

- 1 Directly charge the lock by connecting the USB-C charging cable to the indoor back panel.

Notes: Please charge the battery using the 5V $\overline{=}$ 2A charger. Exceeding this input parameter may cause battery damage or danger.

Disclaimer: In case of any battery damage, electric leakage or fire caused by not following the instruction, our company will not bear any legal liability arising therefrom.

For more use instructions and product information, please scan the QR code in the Chapter "Door Lock Installation", or operate as guided by the app.

Precautions: Please watch your hands when opening the door.

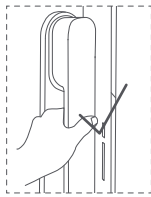
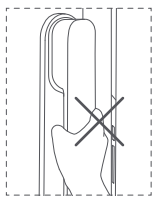

Local Settings Mode

In case of any inconvenience to use Aqara Home app, briefly press the "Setting" button under the battery cover of the door lock and then you can proceed as follows

- Add/remove common users;
- Set the volume of door lock;
- Reset and bind to HomeKit;
- Set the voice and language of the door lock (Chinese/English/Russian).

Tips: Prior to entering the local setting mode, please finish the operation of adding the door lock and users through Aqara Home App.

Specifications

Product Name: Smart Door Lock D100 Zigbee Edition

Product Model: ZNMS20LM

Product Size: 393.8*74.2*58.6 mm

Net Weight: 4.2kg

Power Supply Mode: 2480mAh lithium-ion battery (7.2V===),

USB-C emergency power supply (5V ----)

Wireless Protocols: Zigbee, Bluetooth 5.0, NFC

Operating Humidity: 0-93% RH, non-condensing

Operating Temperature: -10°C -55°C

*The Bluetooth® word mark and logos are registered trademarks owned by Bluetooth SIG, Inc. and any use of such marks by Lumi United Technology Co., Ltd. is under license. Other trademarks and trade names are those of their respective owners.

* Please read this manual carefully before using the product and keep it properly.

Online Customer Service: www.aqara.com/support

E-mail: support@aqara.com

Manufacturer: Lumi United Technology Co., Ltd.

Address: 8th Floor, JinQi Wisdom Valley, No.1 Tangling Road, Liuxian Ave, Taoyuan Residential District, Nanshan District, Shenzhen, China.

See www.aqara.com for more information of the product.